

**Zeitschrift:** Hochparterre : Zeitschrift für Architektur und Design  
**Band:** 19 (2006)  
**Heft:** [15]: Schindler Award for Architecture 2006 "Access for All" [english]

**Artikel:** Fifth prize : a river balcony  
**Autor:** [s.n.]  
**DOI:** <https://doi.org/10.5169/seals-123044>

### **Nutzungsbedingungen**

Die ETH-Bibliothek ist die Anbieterin der digitalisierten Zeitschriften. Sie besitzt keine Urheberrechte an den Zeitschriften und ist nicht verantwortlich für deren Inhalte. Die Rechte liegen in der Regel bei den Herausgebern beziehungsweise den externen Rechteinhabern. [Siehe Rechtliche Hinweise.](#)

### **Conditions d'utilisation**

L'ETH Library est le fournisseur des revues numérisées. Elle ne détient aucun droit d'auteur sur les revues et n'est pas responsable de leur contenu. En règle générale, les droits sont détenus par les éditeurs ou les détenteurs de droits externes. [Voir Informations légales.](#)

### **Terms of use**

The ETH Library is the provider of the digitised journals. It does not own any copyrights to the journals and is not responsible for their content. The rights usually lie with the publishers or the external rights holders. [See Legal notice.](#)

**Download PDF:** 17.11.2024

**ETH-Bibliothek Zürich, E-Periodica, <https://www.e-periodica.ch>**

# A River Balcony

The author of this project regarded the approach as almost more important than the goal. She tried to improve the existing situation with minimal but careful interventions. The jury appreciated her undeviating course of action and her careful, respectful treatment of the existing substance.

• The author undertook three analytical steps. First of all she examined the concept of disability and translated her conclusions into practical solutions for improvements to the existing situation. Secondly, she analyzed the accessibility of the building and its surroundings. What were its shortcomings? What could be changed? Thirdly, she organized the results into a consistent programmatic form and expressed them in a coherent architectural language.

The dominant element of the project is a series of moving walkways that start at the Seine embankment, lead through the Palais de Tokyo courtyard and end in the Avenue Wilson. During their stroll, visitors can stop at a projecting platform and enjoy the views up and down the Seine. A shallow pool in the outer courtyard reflects the building, representing the integration of man and nature. A similar procedure is applied to the interior of the Palais de Tokyo. The project is distinguished by its accessibility concept, which can be applied anywhere. The use of effective and sensitive solutions for disabled people, such as textile surfaces, supportive colors, ergonomic handrails and helpful signals, are abundant.

The exhibition concept plays on these elements, putting them to the test by enabling nondisabled people to experience what it is like to be disabled. This project convinced the jury by virtue of its modest approach and careful elaboration of the issues of accessibility. •

--> Student: Marta Bordas Eddy

--> Professor: Miguel Usandizaga

--> School: Technical University of Catalonia, Barcelona E

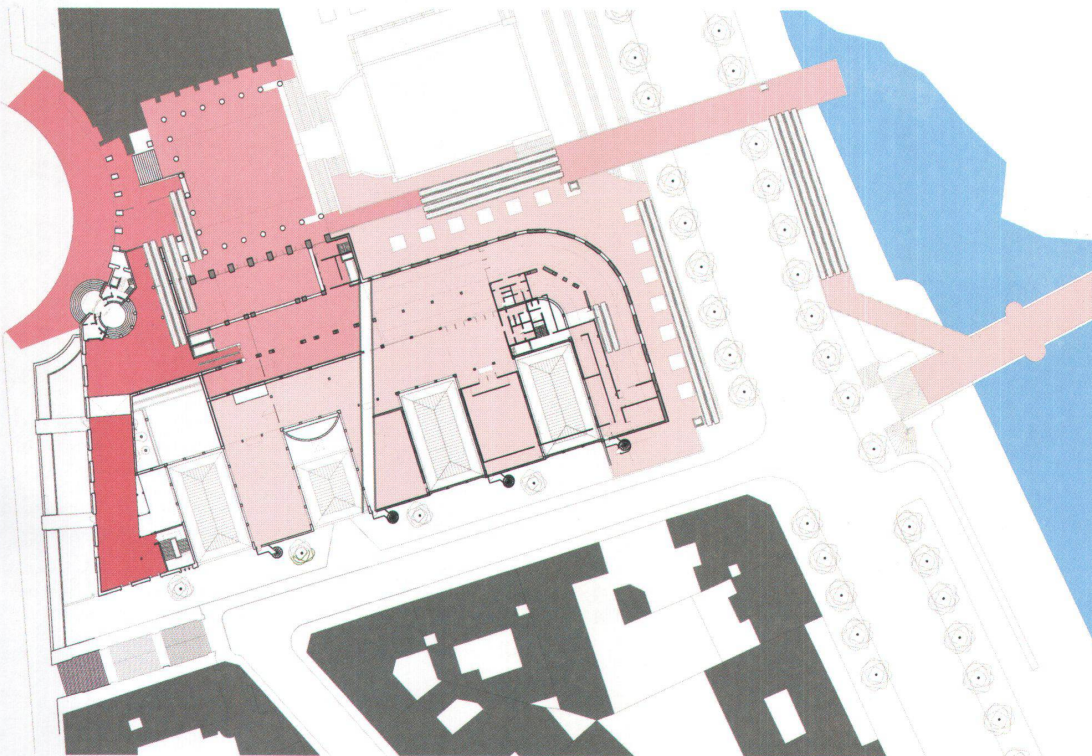
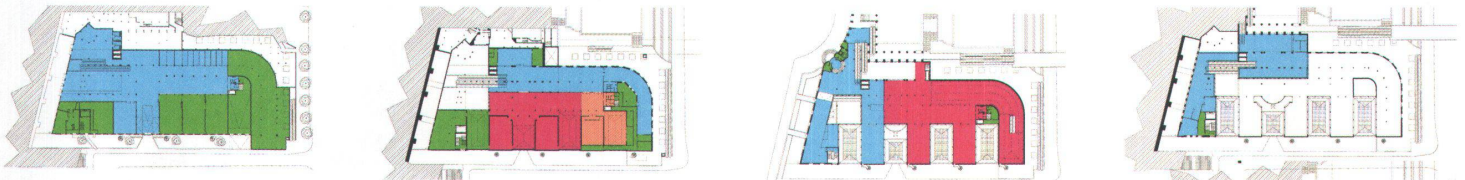

1 The basement, entresol, ground and upper floors of the Palais de Tokyo bear witness to the careful elaboration of the project.

2 The pathway consists of a series of moving walkways that guarantee access for disabled people.

3 The platform projecting far out over the Seine integrates the project in the historical river landscape.